

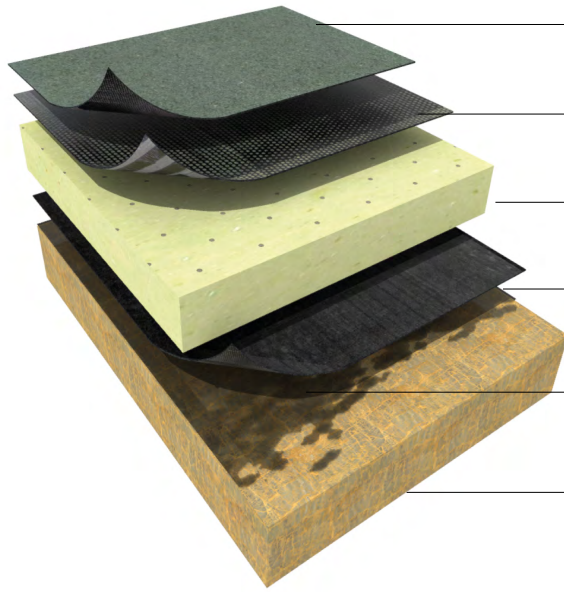

**TA-30 Flat Roofing System**



PARAFOR SOLO GS CAP SHEET

ADEPAR JS W UNDERLAY

PARAFOAM ULTRA PIR INSULATION\*

PAREVAPO SBS AIR AND VAPOUR CONTROL LAYER (AVCL)

LANGLEY SPRAY-ON PRIMER

EXISTING BUILD-UP OR GENERIC DECK

Example installation depth shown above is typical.

	Layer	Thickness	Weight
1	Parafor Solo GS	5mm (4mm at selvedge)	5.71g/m <sup>2</sup>
2	Adepar JS	3mm	3.6kg/m <sup>2</sup>
3	Parafoam Ultra	30 - 250mm (10mm increments)	3.84kg/m <sup>2</sup> (120mm)
4	Parevapo SBS	3mm	3.8kg/m <sup>2</sup>
Total System Weight		(based on 120mm insulation thickness)	16.95kg/m <sup>2</sup>

**TA-30**

The TA-30 system, part of the Langley Parafor range, is a premium quality, torch applied, high performance SBS elastomeric membrane warm roof system for flat or sloping roofs which carries a 30 year independently insured guarantee covering design, materials, workmanship and consequential loss. The cap sheet is available in several colours for architectural purposes and delineating walkways etc.

**WHEN TO SPECIFY**

This system is for new build or refurbishment projects (where conditions allow, existing systems can be overlaid, avoiding costly strip-ups). Suitable for all roof decks (timber boarding requires a nailed attachment layer in accordance with BS 8747:2007).

\* Additional insulation thicknesses are available or as a tapered (cut to falls) option.

**SPECIFICATION SUPPORT**



Free, no-obligation roof condition survey, where a data driven report is collated, supporting a cost-effective and compliant refurbishment specification and planned preventative maintenance (PPM) programme as part of estate asset management.



Bespoke specifications include detailed sectional drawings, insulation and rooflight drawings. Other non-standard drawings are created that generic would not cover such as fire risk areas.



Choosing Langley ensures that your project is technically monitored throughout, from its specification through to a full assurance guarantee once the roof installation is complete.

**ACCREDITATIONS**





### RESISTANCE

- TA-30 membranes are covered by MOAT 31 (Reinforced Homogenous coverings of SBS Elastomeric Bitumen).
- Parafor Solo GS achieves a 'resistance to damage' rating R4 (the highest level of acceptance) under MOAT 31.
- Fire Rating: Broof(t4) BS EN 13501-5:2016



### DURABILITY

- Extremely robust, yet flexible roof covering, 8mm thick (5mm cap sheet, 3mm underlay).
- Slip resistant granule surface provides ample durability and puncture resistance for maintenance foot traffic.
- Durable glass fibre reinforced vapour check provides a robust, watertight layer.



### LIFE SPAN

- Long-term solution, life expectancy of at least 40 years.



### CERTIFIED AND PROVEN

- Parafor and Paradiene membranes are covered by a BBA Agrément Certificate.
- Original SBS elastomeric bitumen membrane system
- Products used in the UK and Europe since 1987
- In accordance with guidance outlined within NHBC technical requirements for flat roofs and balconies.



### GUARANTEED

- The system carries a 30 year independently insured guarantee for materials, design, workmanship and consequential loss.
- Installed by our national network of Langley Approved Contractors and installers, ensuring only the highest quality of installation is maintained.
- User friendly, quick and easy to install.
- A full range of accessories/supporting products are included under a single comprehensive guarantee, which includes: rooflights, refurbishment outlets, vents, lead-free flashings, edge trims etc.
- All Langley elastomeric membranes have been developed in accordance with the European Union of Agrément (UEAtc) and are manufactured and tested in accordance with UEAtc MOAT special directives (Methods of Assessment and Testing).



For users peace of mind, this system is supported by the full Langley package that includes: surveys, condition reports and proposals, specifications, site monitoring and reporting, technical and design advice, guarantee inspections, all at no additional cost.

### HOLISTIC PACKAGE

The above information is issued in good faith and without warranty and is intended as a guide only. The information comprises typical data and does not constitute a specification.

## REINFORCED BITUMINOUS MEMBRANE ACCESSORIES

