

CDM RESIDUAL RISK REGISTER

IN ADDITION TO THE HAZARDS / RISKS NORMALLY ASSOCIATED WITH THE TYPES OF WORK DETAILED ON THIS DRAWING NOTE THE FOLLOWING:

1. ALL CABLING ON EXTERNAL WALL ELEVATIONS WILL REQUIRE APPROPRIATE & APPROVED ACCESS STRATEGIES FOR EXPOSED WORKS AT HEIGHT.
- 2.

1. CONSTRUCTION
THE BUILDING REGULATIONS PART L2B SHALL BE COMPLIED WITH IN RESPECT TO INSPECTION AND COMMISSIONING

2. MAINTENANCE / CLEANING
HSE WORK PLACE REGULATIONS SHALL BE OBSERVED

3. DECOMMISSIONING / DEMOLITION
WEE AND ROHS REGULATIONS SHALL BE COMPLIED WITH

N.B. IT IS ASSUMED THAT ALL WORK WILL BE CARRIED OUT BY A COMPETENT CONTRACTOR WORKING, WHERE APPROPRIATE, TO AN APPROVED METHOD STATEMENT

This document is copyright of TGA Consulting Engineers LLP and must not be reproduced without their permission. Drawing measurements shall not be obtained by scaling. This document should be read in conjunction with associated models, specifications and related documents.

Standard construction hazards that a competent contractor would be aware of have not been identified on this drawing. Any risks not immediately apparent are identified within the CDM Residual Risk Register.

- LEGEND
- PRIMARY RISER LOCATIONS FOR ALL IRS & COMMS SERVICES
 - COMMUNITY FIBRE (CF) DISTRIBUTION BOX AT FLOOR LEVEL

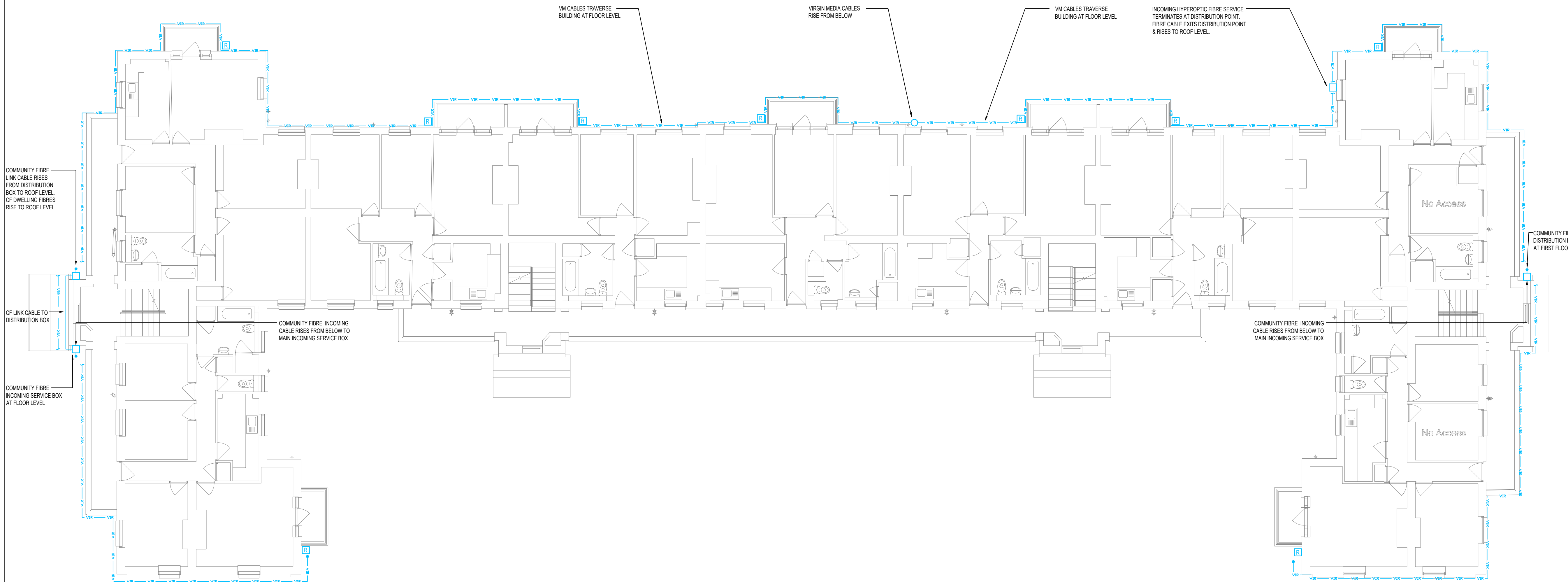

BRAMLEY HOUSE: FIRST FLOOR FLOOR PLAN
SCALE 1:100

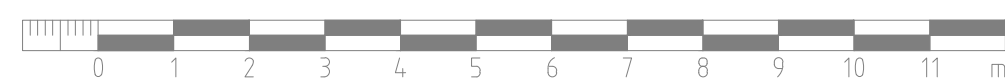

P01	27.02.23	ISSUED FOR TENDER PURPOSES	LC	SJO
REV	DATE	DESCRIPTION	DRAWN	APP

tga CONSULTING ENGINEERS
a sustainable future... engineered.

TGA Consulting Engineers LLP, Building 3 Gateway 1000, Arlington Business Park, Stevenage, SG1 2FP.
E: info@tgace.co.uk T: 01438 314422

Project
ROYAL BOROUGH OF KENSINGTON & CHELSEA
BRAMLEY HOUSE

Title
ELECTRICAL ENGINEERING SERVICES
EXISTING FIRST FLOOR LEVEL
IRS SYSTEMS

Architect
N/A
Client
ROYAL BOROUGH OF KENSINGTON & CHELSEA

Suitability: Code Description
D2 FOR TENDER

Revision:	Scale:	TGA Proj No:	Stage:
P01	1:100	8232	3

Drawing Reference:
Project-Originator-Zone-Level-Type-Role-Classification-Number
LWBH-TGA-00-01-DR-E-64-0001